

ISO A1 594mm x 841mm
Approved: EG
Checked: LB
Designer: CM
Project Management Initials:
Last saved by: CLONA MURPHY(2022.05.18) Last Plotted: 2022.05.20
Filename: I:\EU\AECOM\NET\COM\EU\PROJECT\VOLUME\B2\TP\PROJECTS\HIGHWAYS - GALWAY PARKMORE\03 EXECUTION\08 CAD\20 SHEETS\01 WIP\P1.0160526720-SHT-00-P1.01-CH-01.40.00-140.04 REV 02.DWG

EXISTING CROSS SECTION

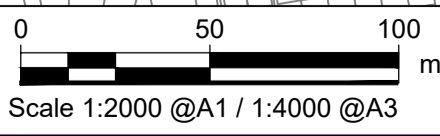
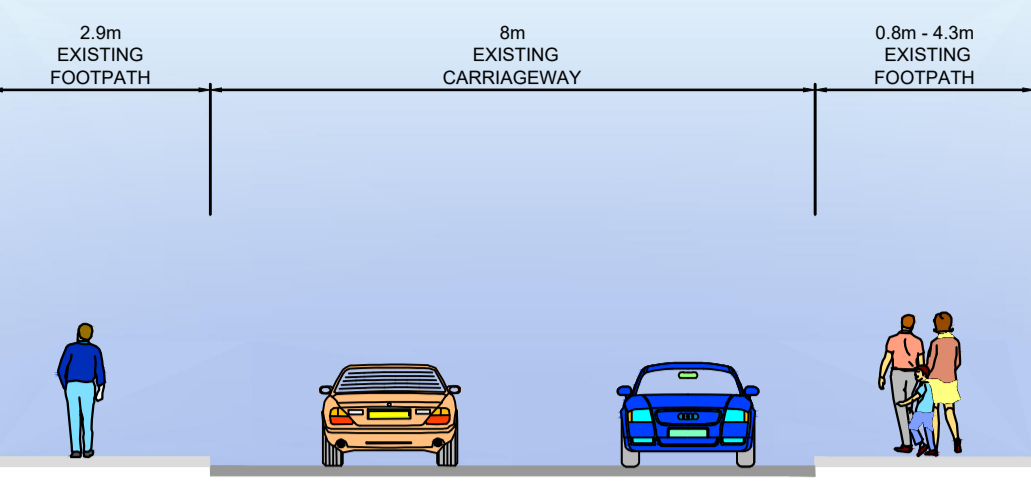

Parkmore Road Bus Priority
Public Consultation June 2022

Please see www.galwaycity.ie/parkmore for the online feedback form and Section 38 report

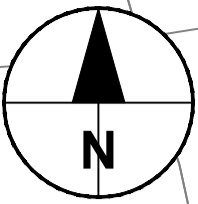

AECOM

PROJECT

**PARKMORE
ROAD BUS
PRIORITY SCHEME**

CLIENT

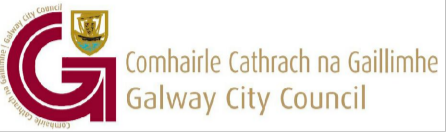

CONSULTANT

AECOM
Adelphi Plaza
Georges Street Upper
Dun Laoghaire
County Dublin
Ireland
T +353 (0)1 2383100
www.aecom.com

LEGEND

- SITE BOUNDARY
- PROPOSED KERB
- PROPOSED RAISED PEDESTRIAN CROSSING
- PEDESTRIAN FOOTPAH
- BUS LANE
- BUS STOP
- CARRIAGEWAY
- LANDSCAPED AREA
- TACTILE PAVING
- SIGNAL POLE
- EXISTING TREE TO BE REPLACED
- PROPOSED NEW TREE LOCATION
- EXISTING TREE TO BE MAINTAINED

NOTES:

ALL EXISTING ACCESSES MAINTAINED

ISSUE/REVISION

POI	25/04/2022	S38 FINAL
I/R	DATE	DESCRIPTION

DRAWING STATUS

FOR REVIEW

PROJECT NUMBER

60526720

SHEET TITLE

P01.01 - PARKMORE ROAD
BUS PRIORITY
PRELIMINARY DESIGN - LAYOUT

SHEET NUMBER

60526720-SHT-00-P1.01-CH-0140.00

ORDNANCE SURVEY IRELAND LICENCE NO 2021/16/CCMA/GalwayCityCouncil
© ORDNANCE SURVEY IRELAND / GOVERNMENT OF IRELAND

This drawing has been prepared for the use of AECOM's client. It may not be used, modified, reproduced or relied upon by third parties, except as agreed by AECOM or as required by law. AECOM accepts no responsibility, and denies any liability whatsoever, to any party that uses or relies on this drawing without AECOM's express written consent. Do not scale this document. All measurements must be obtained from the stated dimensions.

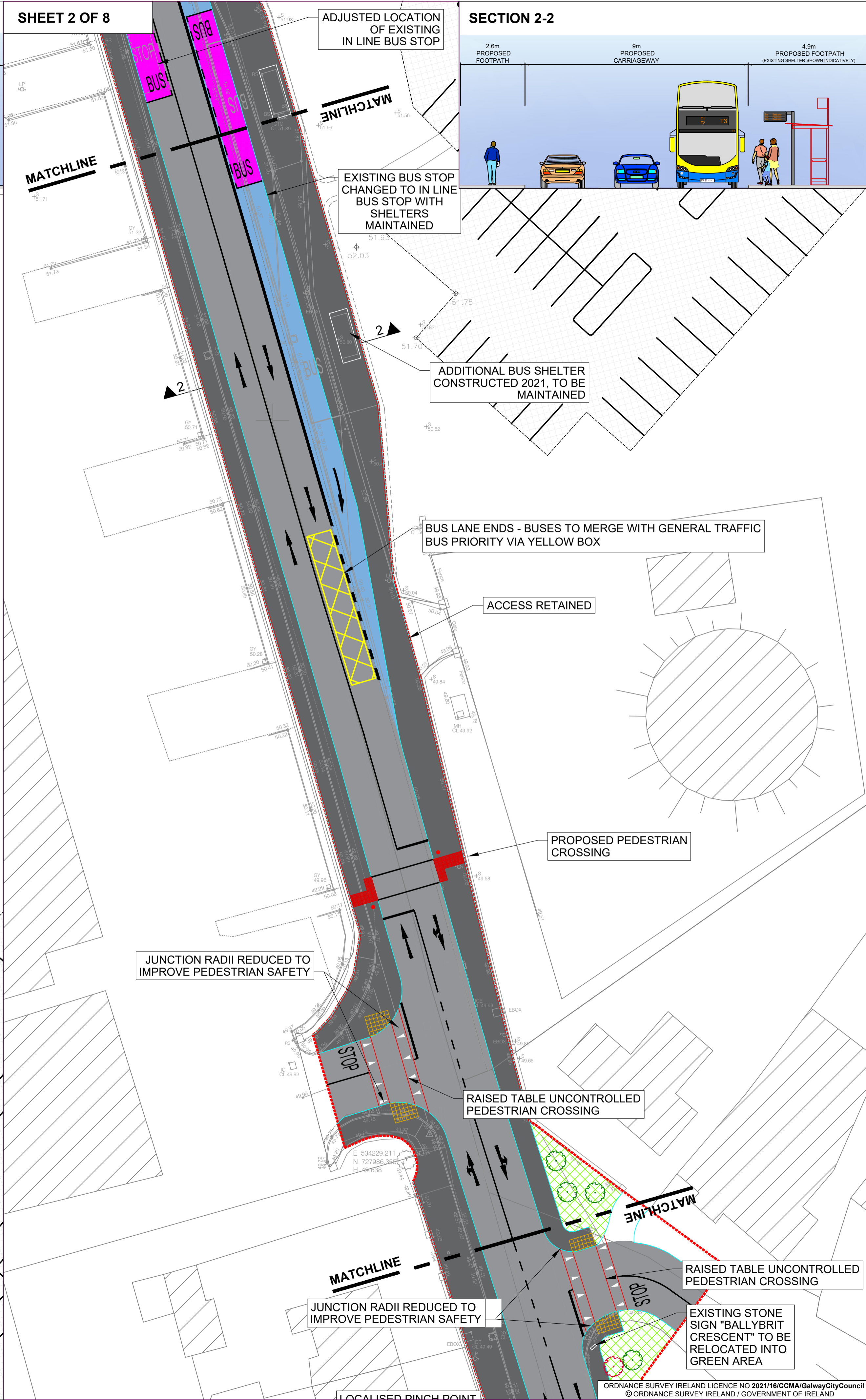
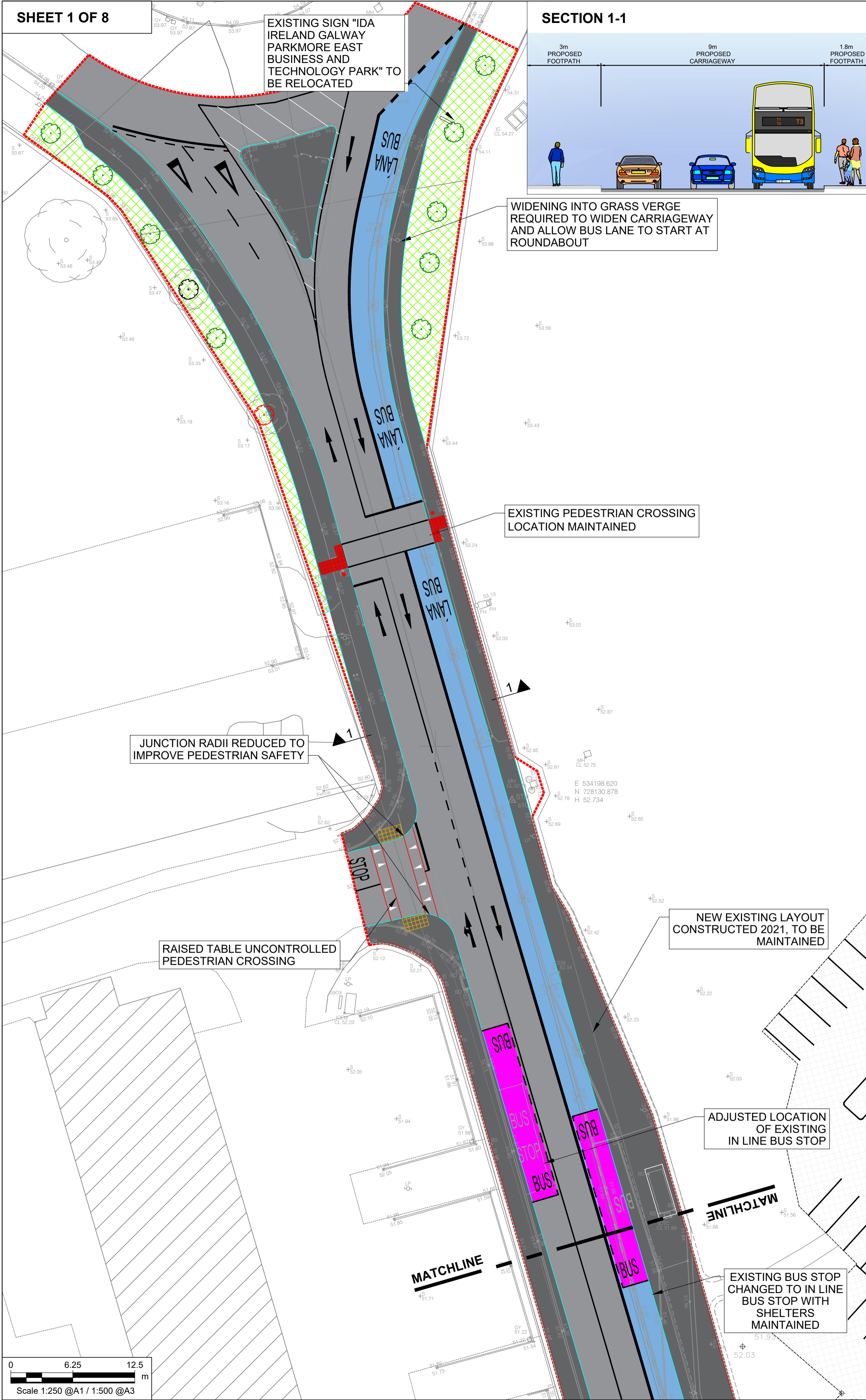

PROJECT

PARKMORE ROAD BUS PRIORITY SCHEME

CLIENT

Galway City Council
 National Transport Authority

CONSULTANT

AECOM
Adelphi Plaza
Georges Street Upper
Dun Laoghaire
County Dublin
Ireland
T +353 (0)1 2383100
www.aecom.com

- LEGEND**
- SITE BOUNDARY
 - PROPOSED KERB
 - PROPOSED RAISED PEDESTRIAN CROSSING
 - PEDESTRIAN FOOTPAH
 - BUS LANE
 - BUS STOP
 - CARRIAGEWAY
 - LANDSCAPED AREA
 - TACTILE PAVING
 - SIGNAL POLE
 - EXISTING TREE TO BE REPLACED
 - PROPOSED NEW TREE LOCATION
 - EXISTING TREE TO BE MAINTAINED

NOTES:

ALL EXISTING ACCESSES MAINTAINED

ISSUE/REVISION		
POI	25/04/2022	S38 FINAL
I/R	DATE	DESCRIPTION

DRAWING STATUS

FOR REVIEW

PROJECT NUMBER

60526720

SHEET TITLE

P01.01 - PARKMORE ROAD BUS PRIORITY DESIGN - SHEET 1 OF 4

SHEET NUMBER

60526720-SHT-00-P1.01-CH-0140.01

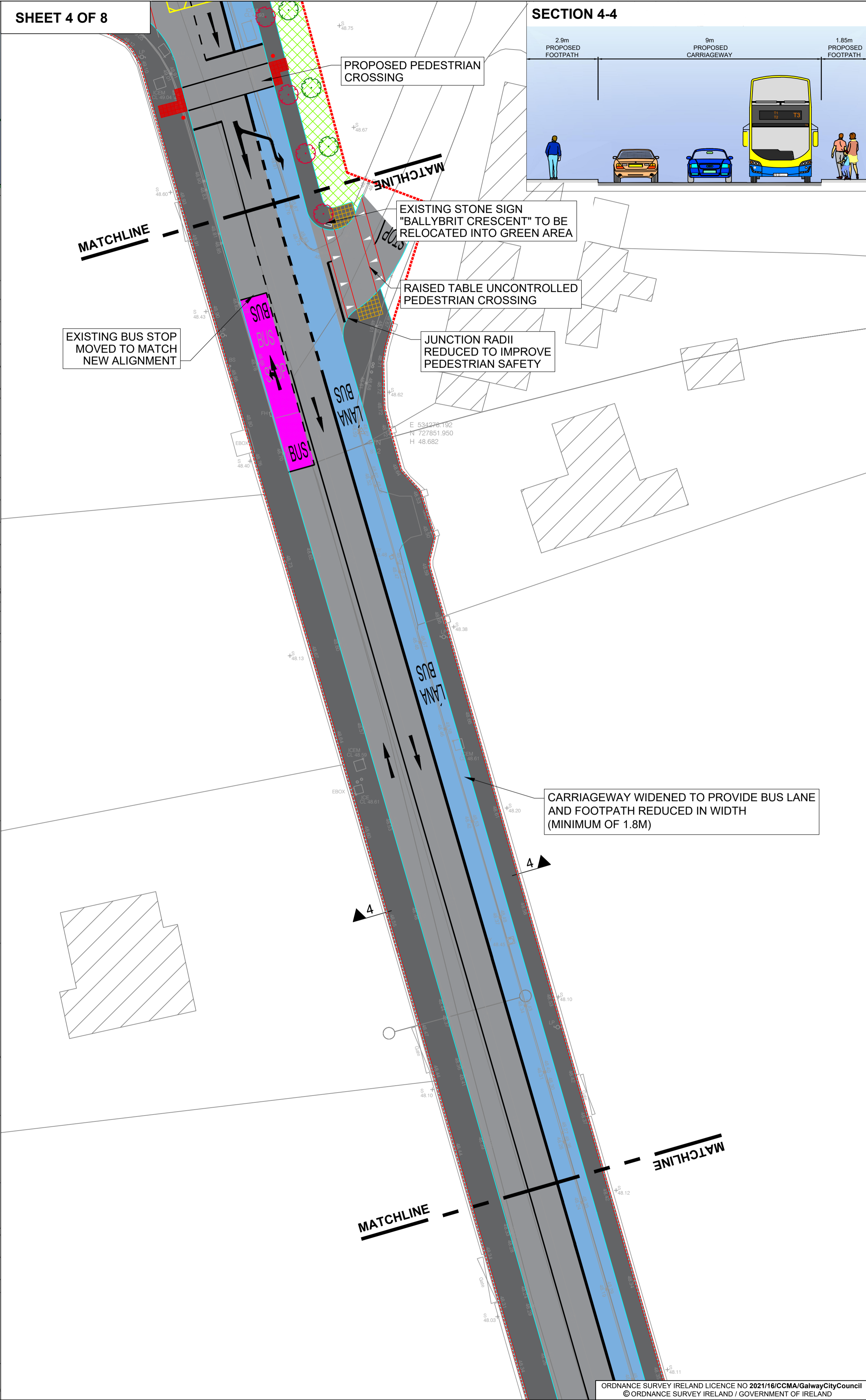
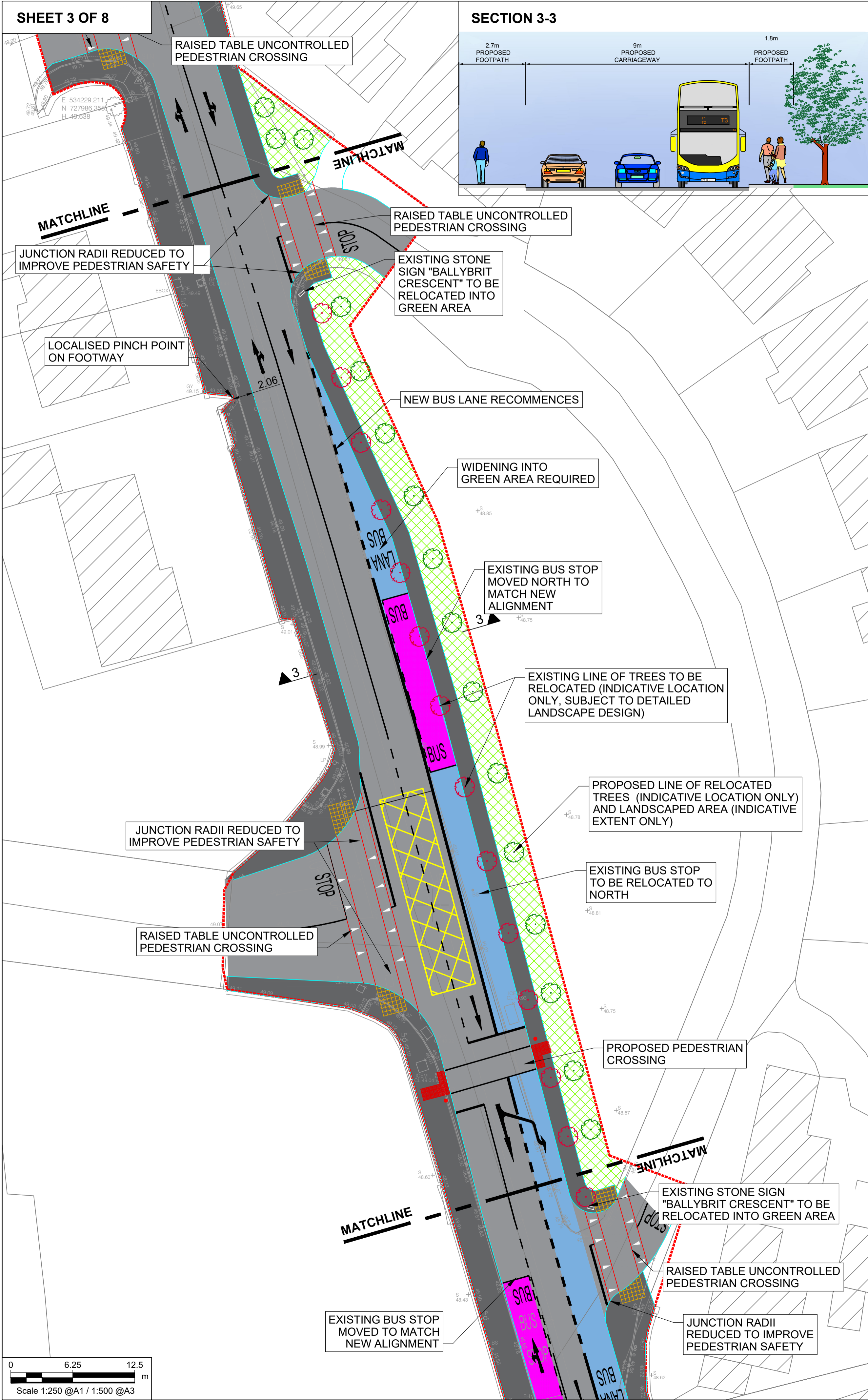

PROJECT

PARKMORE ROAD BUS PRIORITY SCHEME

CLIENT

 **Comhairle Cathrach na Gaillimhe**
Galway City Council

 **Udarás Náisiúnta Iompair**
National Transport Authority

CONSULTANT

AECOM
Adelphi Plaza
Georges Street Upper
Dun Laoghaire
County Dublin
Ireland
T +353 (0)1 2383100
www.aecom.com

- LEGEND**
- SITE BOUNDARY
 - PROPOSED KERB
 - PROPOSED RAISED PEDESTRIAN CROSSING
 - PEDESTRIAN FOOTPAH
 - BUS LANE
 - BUS STOP
 - CARRIAGEWAY
 - LANDSCAPED AREA
 - TACTILE PAVING
 - SIGNAL POLE
 - EXISTING TREE TO BE REPLACED
 - PROPOSED NEW TREE LOCATION
 - EXISTING TREE TO BE MAINTAINED

NOTES:

ALL EXISTING ACCESSES MAINTAINED

ISSUE/REVISION

NO	DATE	DESCRIPTION

POI	25/04/2022	S38 FINAL
I/R	DATE	DESCRIPTION

DRAWING STATUS

FOR REVIEW

PROJECT NUMBER

60526720

SHEET TITLE

P01.01 - PARKMORE ROAD
BUS PRIORITY
DESIGN - SHEET 2 OF 4

SHEET NUMBER

60526720-SHT-00-P1.01-CH-0140.02

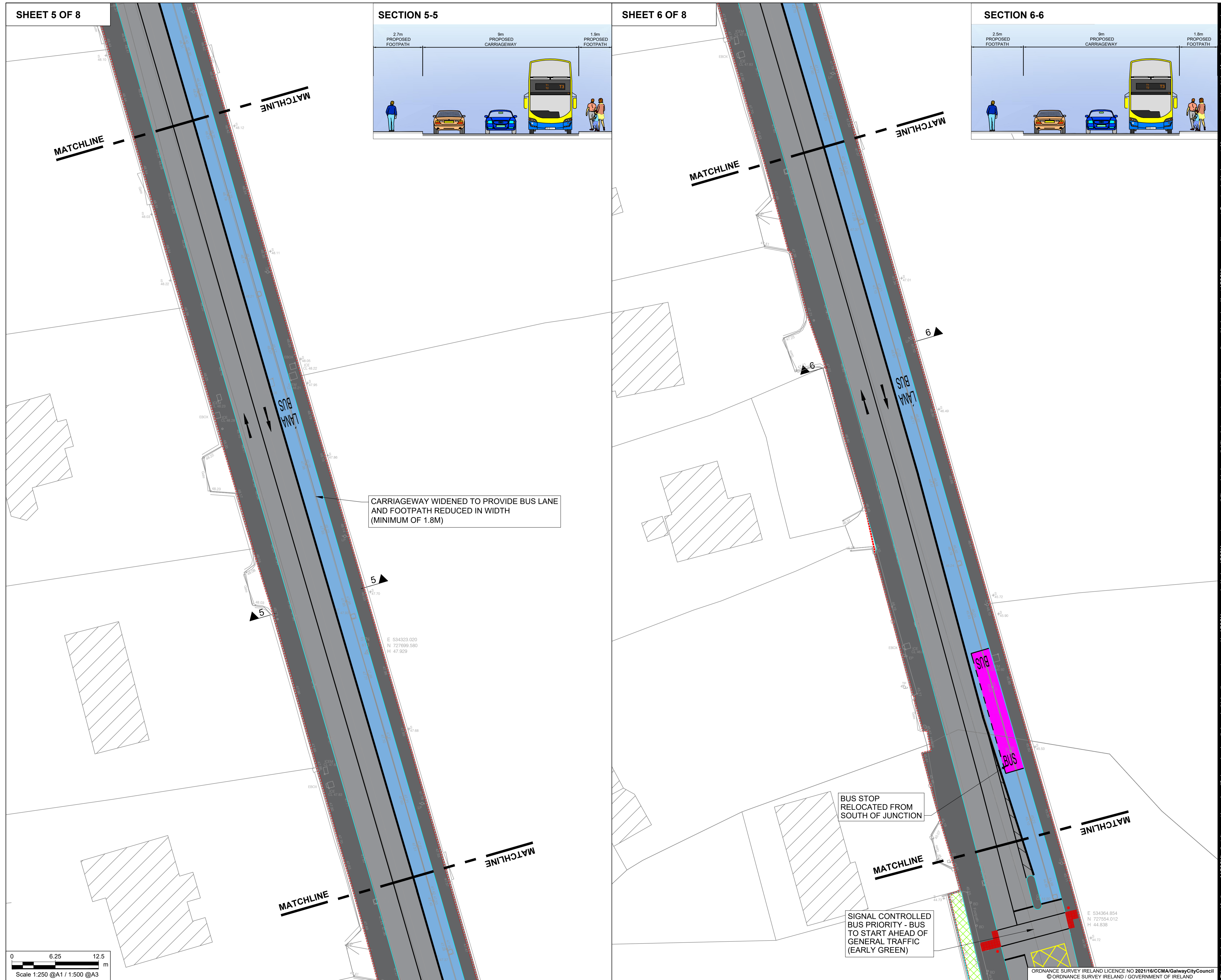

This drawing has been prepared for the use of ALCOM's client. It may not be used, modified, reproduced or relied upon by third parties, except as agreed by ALCOM or as required by law. ALCOM accepts no responsibility, and denies any liability, whatsoever, to any party that uses or relies on this drawing without ALCOM's express written consent. Do not scale this document. All measurements must be obtained from the stated dimensions.



PROJECT

PARKMORE ROAD BUS PRIORITY SCHEME













CLIENT



CONSULTANT

AECOM
Adelphi Plaza
Georges Street Upper
Dun Laoghaire
County Dublin
ireland
T +353 (0)1 2383100
www.aecom.com

LEGEND

- | | |
|---|--|
|  | SITE BOUNDARY |
|  | PROPOSED KERB |
|  | PROPOSED RAISED
PEDESTRIAN CROSSING |
|  | PEDESTRIAN FOOTPATH |
|  | BUS LANE |
|  | BUS STOP |
|  | CARRIAGEWAY |
|  | LANDSCAPED AREA |
|  | TACTILE PAVING |
|  | SIGNAL POLE |
|  | EXISTING TREE TO BE
REPLACED |
|  | PROPOSED NEW TREE
LOCATION |
|  | EXISTING TREE TO BE
MAINTAINED |

NOTES:

ALL EXISTING ACCESSES MAINTAINED

ISSUE/REVISION

POI	25/04/2022	S38 FINAL
I/R	DATE	DESCRIPTION

DRAWING STATUS

FOR REVIEW

PROJECT NUMBER

60526720

SHEET TITLE

P01.01 - PARKMORE ROAD
BUS PRIORITY
DESIGN - SHEET 3 OF 4

SHEET NUMBER

60526720-SHT-00-P1.01-CH-0140.03

ISO A1 594mm x 841mm
Approved: EG
Checked: LB
Designer: CM
Project Management Initials:
Last saved by: CLONVA, MURPHY (2022.05.18)
Filename: \\EU.AECOM\NET\COM\PROJECTS\GALWAY\PROJECTS\HIGHWAYS - GALWAY PARKMORE\03 EXECUTION\08 CAD\20 SHEETS\01 WIPP\1.0160526720-SHT-00-P1.01-CH-0140.00-140.04 REV 02.DWG
Last Plotted: 2022.05.20
Printed on: % Post-Consumer Recycled Content Paper

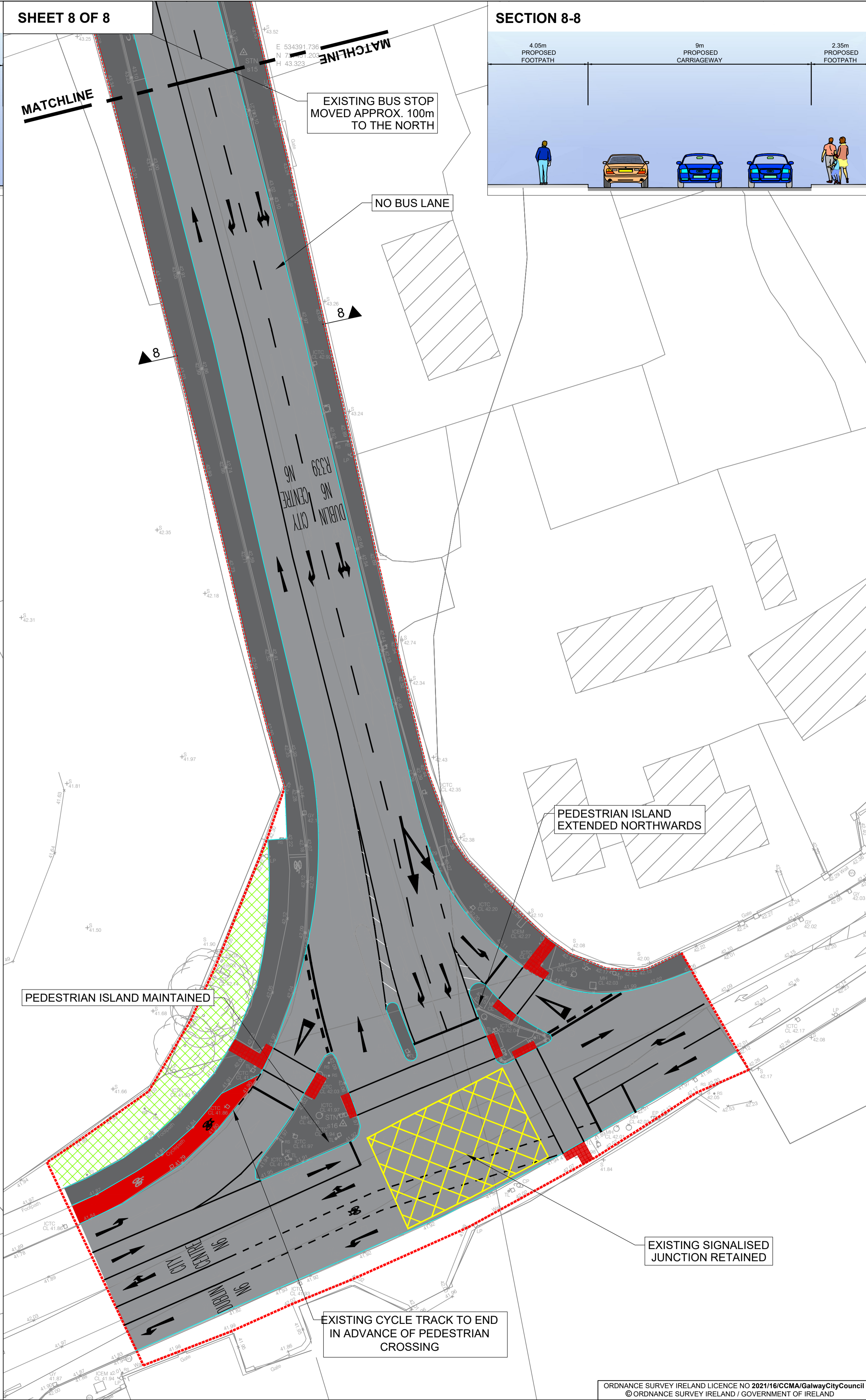
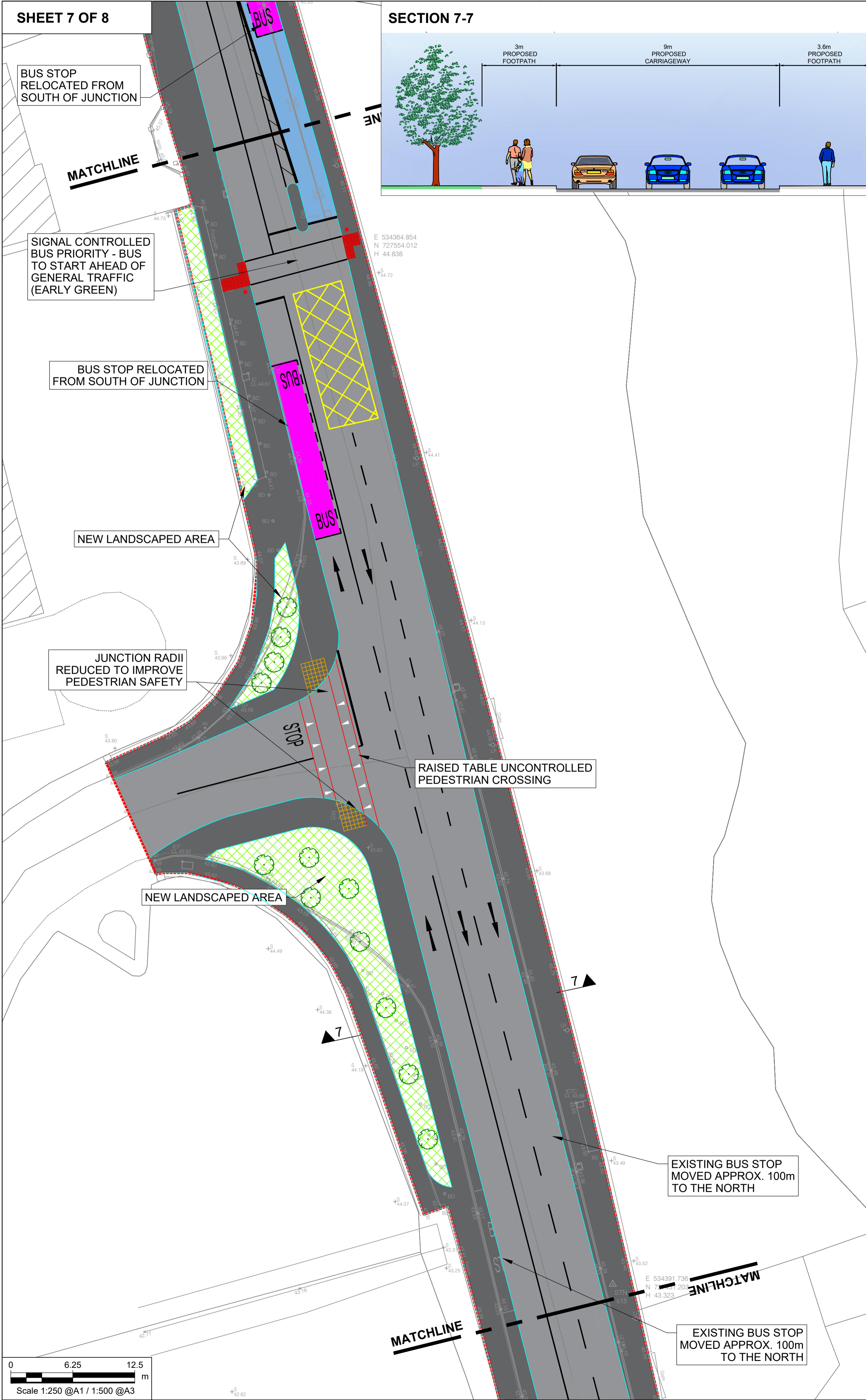

AECOM

PROJECT

PARKMORE ROAD BUS PRIORITY SCHEME

CLIENT

Galway City Council
Udarás Náisiúnta Iompair
National Transport Authority

CONSULTANT

AECOM
Adelphi Plaza
Georges Street Upper
Dun Laoghaire
County Dublin
Ireland
T +353 (0)1 2383100
www.aecom.com

LEGEND

- SITE BOUNDARY
- PROPOSED KERB
- PROPOSED RAISED PEDESTRIAN CROSSING
- PEDESTRIAN FOOTPATH
- BUS LANE
- BUS STOP
- CARRIAGEWAY
- LANDSCAPED AREA
- TACTILE PAVING
- SIGNAL POLE
- EXISTING TREE TO BE REPLACED
- PROPOSED NEW TREE LOCATION
- EXISTING TREE TO BE MAINTAINED

NOTES:

ALL EXISTING ACCESSES MAINTAINED

ISSUE/REVISION

POI	DATE	DESCRIPTION
25/04/2022 <td>S38 FINAL<td></td></td>	S38 FINAL <td></td>	

DRAWING STATUS

FOR REVIEW

PROJECT NUMBER

60526720

SHEET TITLE

P01.01 - PARKMORE ROAD BUS PRIORITY DESIGN - SHEET 4 OF 4

SHEET NUMBER

60526720-SHT-00-P1.01-CH-0140.04